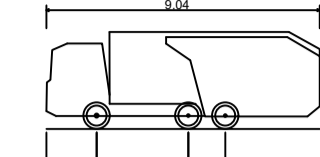
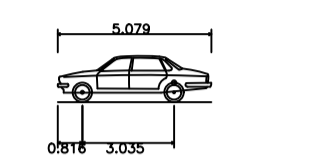

NOTES:

- DO NOT SCALE. USE FIGURED DIMENSIONS ONLY.
- THIS DRAWING IS TO BE READ IN CONJUNCTION WITH ALL OTHER RELEVANT ARCHITECTURAL AND ENGINEERING DRAWINGS.

LEGEND:

	
Phoenix 2 High Capacity Twin Pack 15 (with Elite 2 6x2ML chassis) Refuse Vehicle	
Overall Length	9.040m
Overall Width	2.500m
Overall Body Height	3.295m
Min Body Ground Clearance	0.410m
Track Width	2.500m
Lock-to-lock time	4.00s
Curb to Curb Turning Radius	7.800m
	
Large Car (2006)	
Overall Length	5.079m
Overall Width	1.872m
Overall Body Height	1.575m
Min Body Ground Clearance	0.317m
Max Track Width	1.831m
Lock-to-lock time	4.00s
Curb to Curb Turning Radius	5.900m

Note: Forward Swept Path Analysis Shown in Red. Reverse in Blue

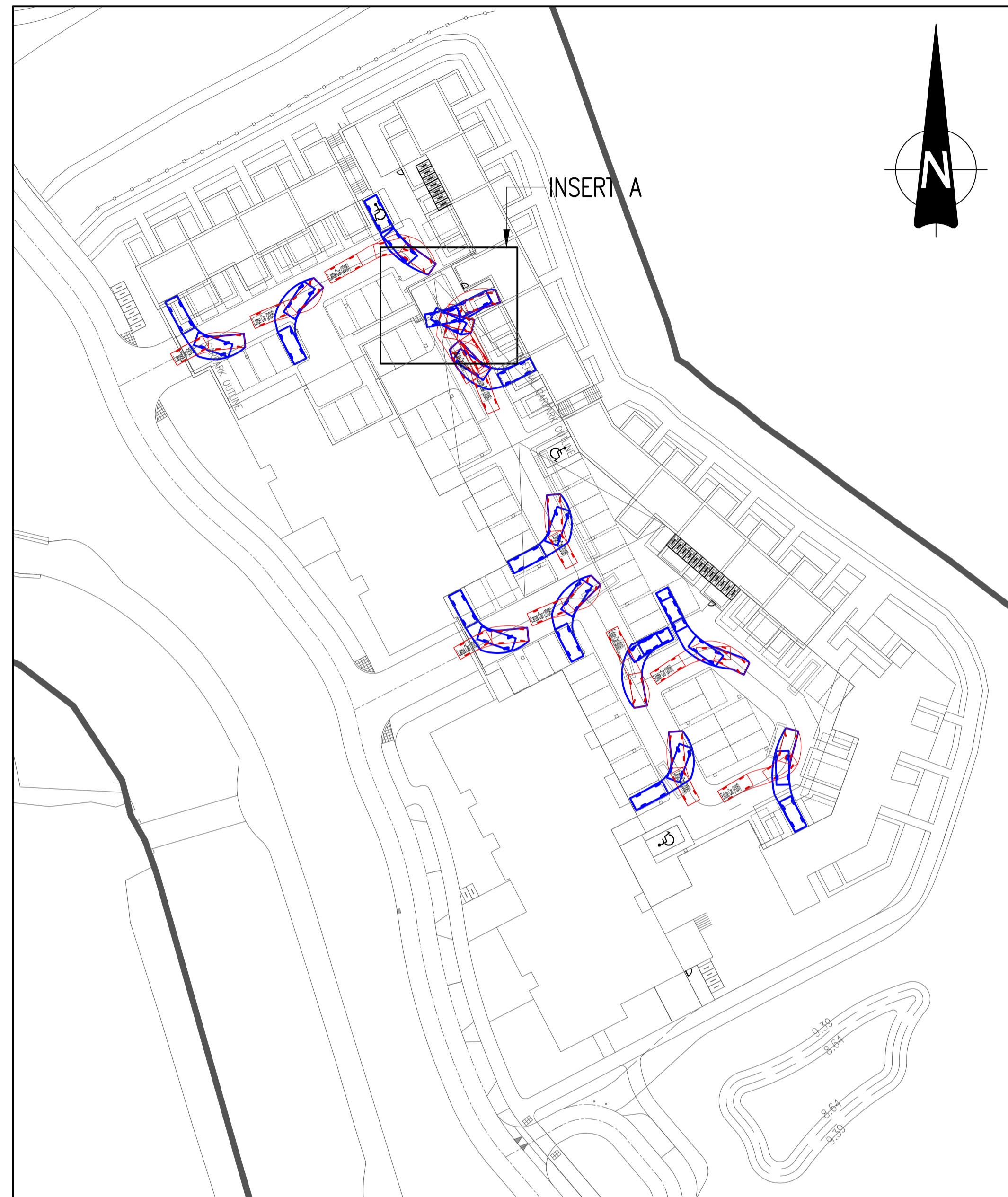

LITTLE AUBURN BASEMENT  
REVERSE PARK FOR A LARGE CAR  
SCALE 1:500

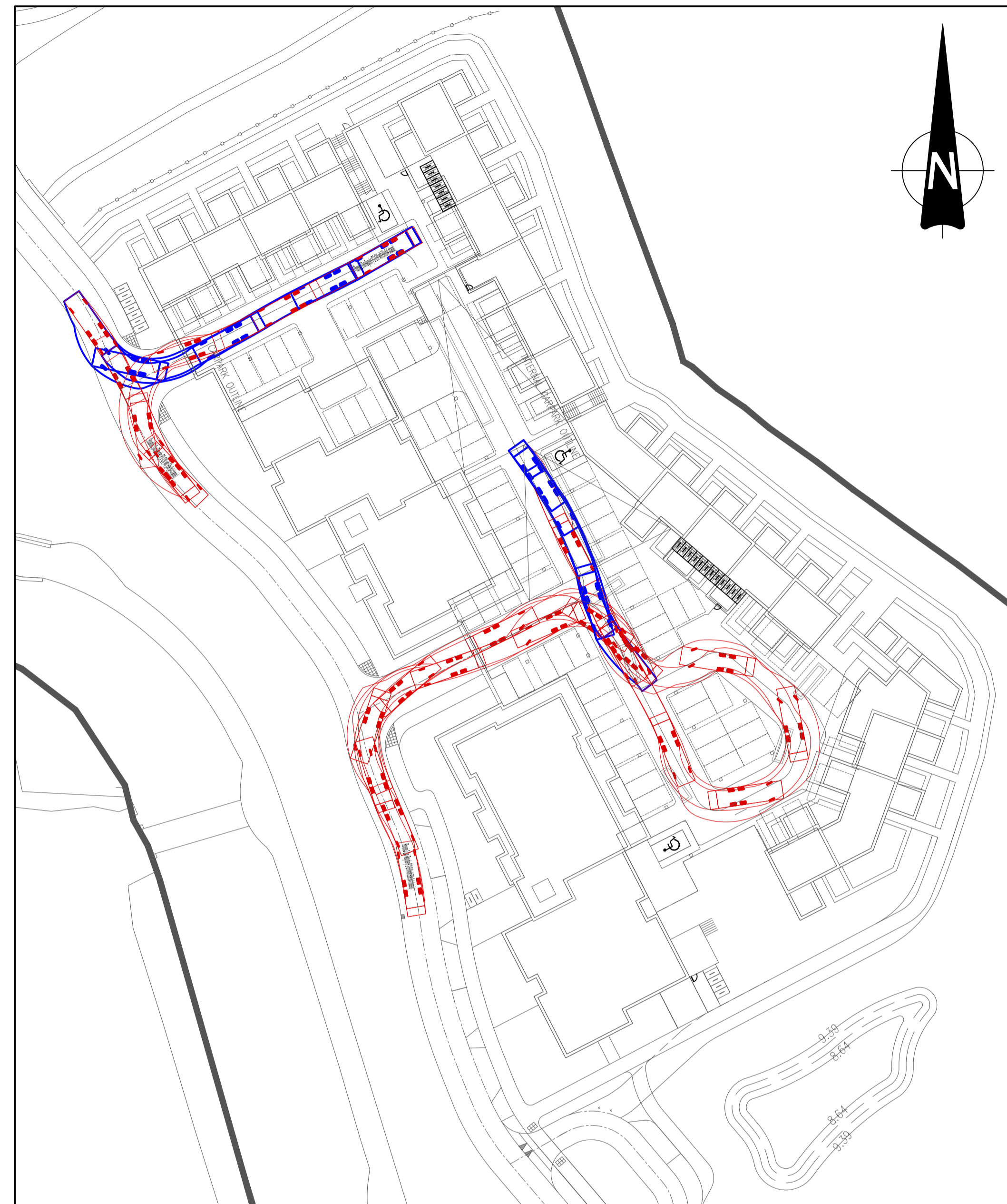

LITTLE AUBURN BASEMENT  
ENTRY/EXIT FOR REFUSE VEHICLE  
SCALE 1:500

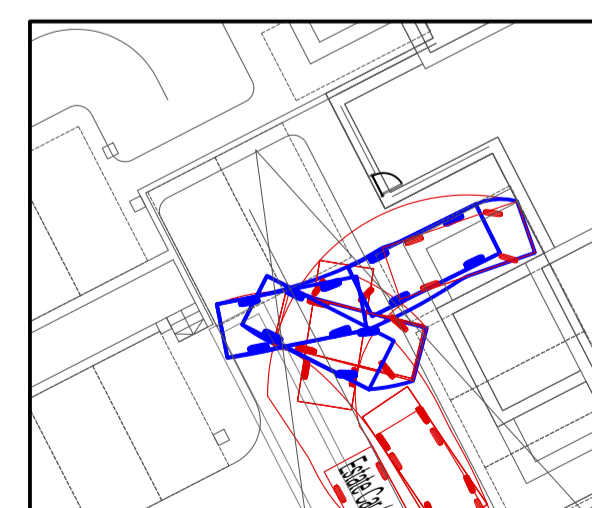

INSERT A  
REVERSE PARK & EXIT  
TO BAY 54  
SCALE 1:250



INSERT A  
REVERSE PARK  
TO BAY 55  
SCALE 1:250

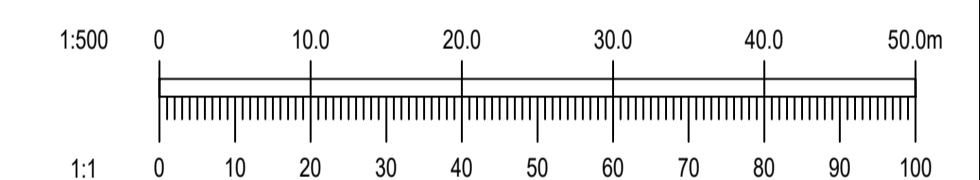

A	07/04/22	REVISED FOR NEW PLANNING APPLICATION	PJD	MD
REV. DATE		AMENDMENT	DRN	APPD

STATUS **PLANNING**

**Waterman Moylan**  
Engineering Consultants  
BLOCK S, EASTPOINT BUSINESS PARK, ALFIE BYRNE ROAD,  
DUBLIN D03 H3F4 IRELAND.  
Tel: (01) 964 8900 Fax: (01) 961 2618  
Email: info@waterman-moylan.ie www.waterman-moylan.ie

CLIENT **KINVEST LTD.**  
ARCHITECT **CONROY CROWE KELLY ARCHITECTS**

PROJECT  
**AUBURN SHD 2**

TITLE  
**LITTLE AUBURN BASEMENT  
SWEEP PATH LAYOUT**

DRAWN PJD	DESIGNED MD	APPROVED MD	DATE FEB '21
SCALE 1:500 @ A1	JOB NO. 19-020	DRG. NO. P143	REVISION A